



## PRODUCT: **YJ Extended Stretch Corner Guards**

REV: A | 09-11-2015 | II-2441

**READ INSTRUCTIONS IN FULL BEFORE INSTALLATION.**

**QUESTIONS? CALL 916-631-8071 M-F 7:00 AM – 5:00 PM PST**

The MetalCloak experience includes the ease of installation of our products. We design for most contingencies, but installation may be different based on different Jeep condition, configuration and/or year.

We are continually trying to improve our products and instructions – please help us by providing feedback and pictures if you find any part of the instructions that do not match your particular Jeep or are not easily understandable.

If you have any difficulties at all, please give us a call. Thank you and enjoy your MetalCloak Products!

**IMPORTANT NOTE: We use Stainless Steel Hardware where possible. Therefore, a tube of Silver Anti-seize is provided and should be used on all bolts—only a small amount is needed.**

**WARRANTY INFORMATION:** This article is sold without warranty expressed or implied. No warranty or representation is made as to this products ability to protect the user from injury or death. The user assumes that risk. The effectiveness, warranty and longevity of this equipment are directly related to the manner in which it is INSTALLED, USED and/or MAINTAINED. THE USER ASSUMES ALL RISK. By purchasing this product and opening the packaging, purchasers expressly acknowledge, understand and agree that they take, select and purchase these MetalCloak products from Armored Works, LLC, its affiliates and distributors and agents as is and with all faults. The entire risk as to the quality and performance of these MetalCloak products is with the purchaser. Working on your vehicle can be a dangerous activity. If you are unsure of what you are doing, please leave mechanical or safety critical work to a skilled mechanic. We take no responsibility for the incorrect use and/or installation of MetalCloak products.

## Section 1: Tools & Notes on Installation

**Tools Required:** This list is the recommended tools for ease of installation. Other versions of the same tool can be used. For example, Allen Wrenches instead of Allen Drive Sockets.



Socket & Ratchet Wrench

Grinder



7/16" Box Wrench  
9/16" Box Wrench  
11/16 Box Wrench

3/8" Socket (with extension)  
7/16" Socket  
9/16" Socket



5/32" Allen Socket or Wrench  
7/32" Allen Socket or Wrench

1/8" Drill Bit      1/4" Drill Bit  
3/8" Drill Bit      17/32" Drill Bit



T25 Torx Screwdriver  
Phillips Head Screwdriver

Drill



**HOW TO USE THIS GUIDE:** The installation guide should be used as a reference for installation. Please read and follow the instructions in order of each page top to bottom, and left to right.

**Jeep Model:** Instructions may apply to multiple Jeep models, but are labeled separately where appropriate (i.e. TJ vs. LJ).

**Options:** Because of the number of component options we offer, these instructions may contain steps that will not match your particular configuration. You can skip these steps.

**Images:** Pictures are provided and parts are labeled throughout the instructions. Each text box contains guidance based on the pictures next to it. The text will refer to alphabetical labels (A, B, etc.) found in the images.

**Installation Notes:** Terms may be used in the body of the instructions that you may not be familiar with, if you have any questions feel free to contact us at the number below, or email [techhelp@metalcloak.com](mailto:techhelp@metalcloak.com)

**QUESTIONS:** Any questions or comments about the instructions? Call us at 916-631-8071 M-F 7:00 AM – 5:00 PM PST.

## Section 2: Product Components



DC-0002 REV B

SHEET 1 OF 1

ITEM	PART NUMBER/DESCRIPTION	QTY.
1	WM-0144 WELDMENT, CORNER GUARD, EXTENDED DRIVER YJ STRETCH MOD	1
2	WM-0145 WELDMENT, CORNER GUARD, EXTENDED PASS YJ STRETCH MOD	1
3	CP-0079 INSTALLATION TOOL, .375-16 RIVET NUT	1
4	CP-0011 BACKING PLATE, TJ REAR FLARE	4
5	FA-0057 RIVET NUT, .375-16 OPEN END ZYC PLTD	7
6	FA-0053 HEX NYL LOCKNUT .375-16 .45TH ZNC PLT STL	35
7	FA-0009 WASHER, .41ID X .81OD X .051TH 18-8 SS SAE	45
8	FA-0004 SCKT BTN SCREW, .375-16x.75L 18-8 SS	4
9	FA-0018 SBHCSCREW, .375-16x1.0L 18-8 SS	42
10	FA-0005 SBHCSCREW, .375-16x1.25L 18-8 SS	8

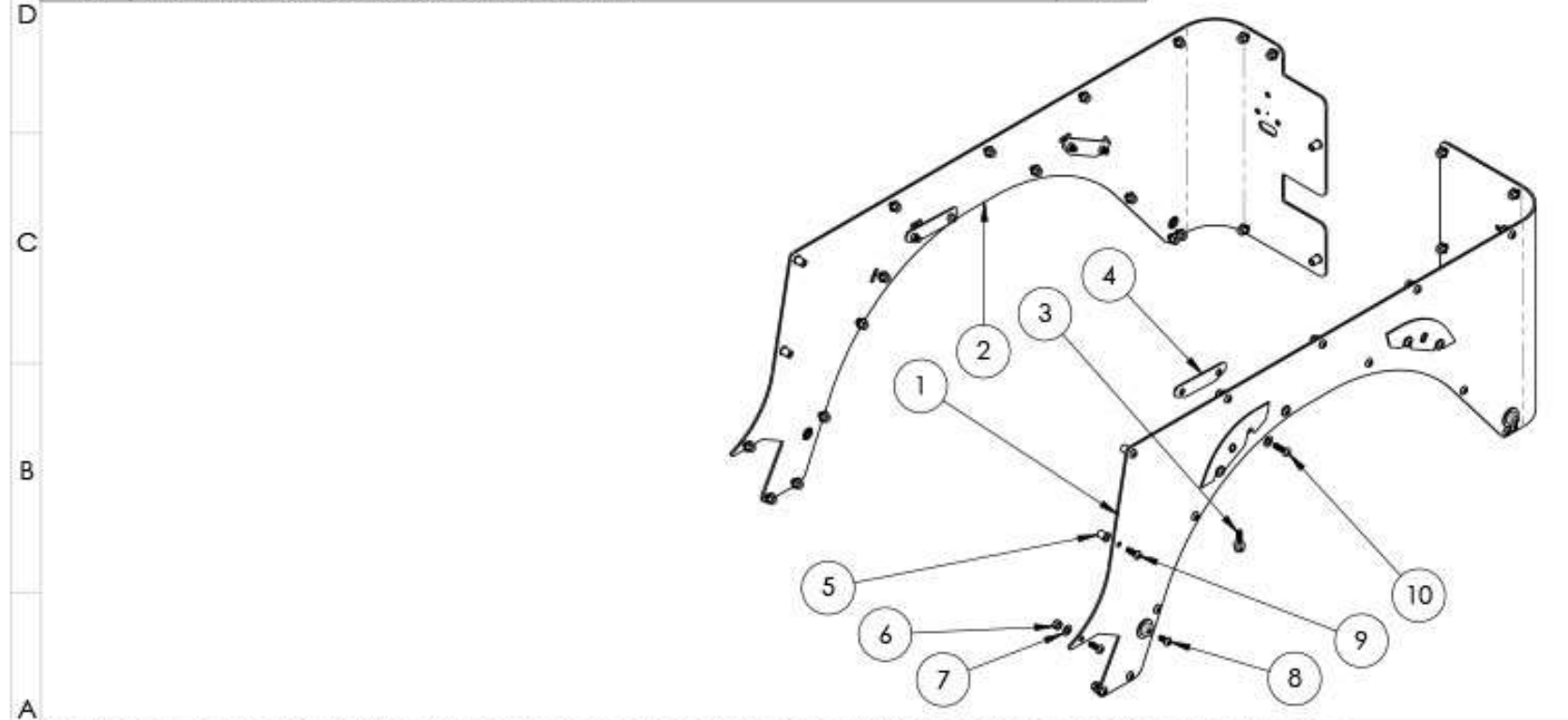

THE INFORMATION CONTAINED IN THIS DOCUMENT IS THE SOLE AND EXCLUSIVE PROPERTY OF ARMORED WORKS, LLC. ANY REPRODUCTION OF THIS DOCUMENT WITHOUT THE WRITTEN PERMISSION OF ARMORED WORKS, LLC. IS STRICTLY PROHIBITED. METALCLOAK IS A DIVISION OF ARMORED WORKS, LLC. FOR MORE PRODUCT INFORMATION GO TO WWW.METALCLOAK.COM



REVISION [A][BAM][09/29/11] PART NUMBER DESCRIPTION

2441 CORNER GUARD, EXTENDED YJ STRETCH MOD

## Section 3: Installation Instructions

**Step 1:** Remove stock components that will interfere with corner guard installation.

Remove Current Rear Fender Flares and Stock Rear Inner Fender liner. Clean all dirt, stock rivet nuts, or protrusions from body.



Remove Rear Brake/Blinker Housings(E) by removing the four Phillips head screws(F) at the corners of the red transparent cover plate of Rear Brake/Blinker Housing(E). Inside the Brake/Blinker Housing remove the three 3/8" hex head cap screws(G), disconnect wiring harness(H) and remove Rear Brake/Blinker Housing(E). Save all hardware for reinstallation.



Remove Rear License Plate Holder by removing the two T25 Torx screws(A). Remove Gas Tank Fill Spout Plastic Retainer(B) by removing the three outer T25 Torx Drive Screws(C) and the 6 inner 5/32" hex head screws(D).



Fix any body damage in order to assure the corner guard can be mounted flush to the Jeep body side, corner and rear.

## Section 3: Installation Instructions

**Step 1:** Fix Corner Guard into position in order to drill holes for holding fasteners.

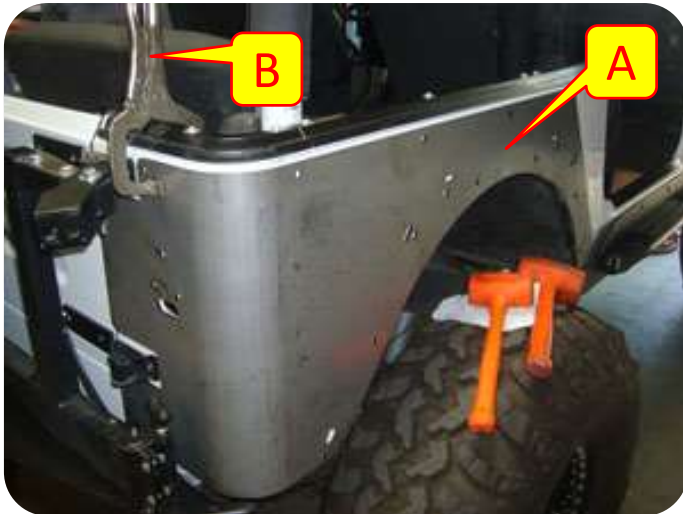

Images show a raw metal Corner Guard(A). Special care must be taken with Powder Coated Corner Guards to protect coating during the installation process. Corner Guard(A) can be installed with Jeep Top installed, however installation is easier if Jeep Top is removed.

Fix Corner Guard(A) into position with C-Clamps or Vice Grips (B) as shown. Be sure to place one clamp at top(C) and one clamp at bottom(D) of the 3" radius bend in Corner Guard(A) and rear corner of the Jeep. Corner Guard(A) should fit tightly(E) to Jeep body corner with minimal gap.



- Inspect points to insure alignment is proper.
- (F) Gas Intake Spout Hole.
  - (G) Rear Brake/Marker Housing mounting holes.
  - (H) Lower edge of Corner Guard(A) and Jeep Body should be flush.
  - (I) 10 to 2 o'clock of Wheel Well of Corner Guard(A) and Jeep Body.

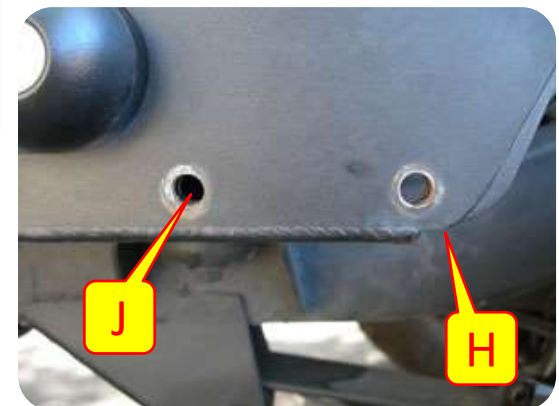
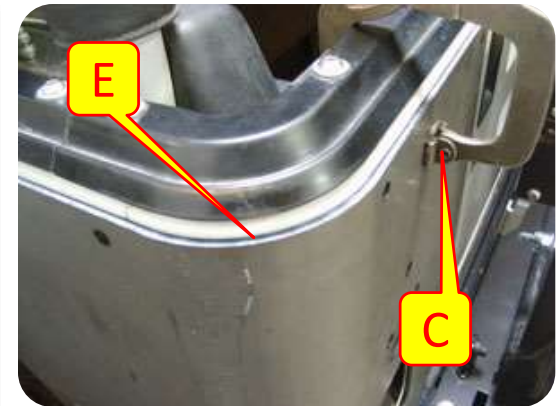

If you have a MetalCloak Rocker Rail check alignment of two bolt holes(J). This is just a check as the Rocker Rail can float forward or backwards on Jeep and should therefore be installed after the Corner Guard(A). The Corner Guard(A) has a fixed position.

## Section 3: Installation Instructions

**Step 2:** Drill all holes in Jeep required for installation.

Center Punch and Pilot Drill (1/8" Drill) all holes marked as follows: ▲ ★ ■



Drill the following holes to the designated finish size without removing Corner Guard.

▲ 3/8" Drill Size

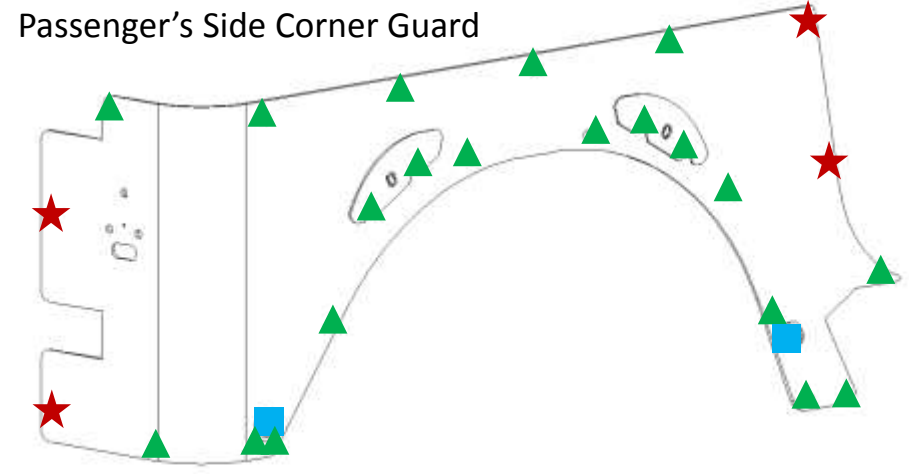
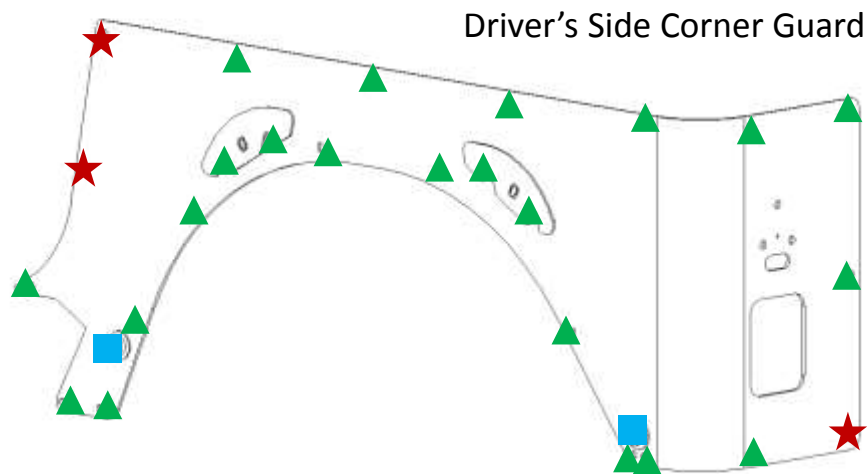

Release all C-Clamps and Vise Grips and Remove Corner Guard from Jeep. Corner Guard will not be needed again until final installation. This is a good time to complete coating/painting of raw metal Corner Guards. After removal of Corner Guard, drill the following holes to finish size.

■ 1/2" Drill Size – Provides clearance hole in Jeep body for Rear Flare retaining bolts.

★ 17/32" Drill Size – Provides hole size for installation of 3/8"-16 Rivet Nut in next step. (1/2" drill may be used, but you just need to widen it out)



## Section 3: Installation Instructions

### Step 1: Install Corner Guards

Fix Corner Guard(A) in position as described in Phase 3 Step 1. Be sure to clamp at top(B) and bottom(C) of Jeep corner. Install the following fasteners at the designated locations:

- ▲ 3/8"-16 x 1" SBHC Screw, 3/8" washer and 3/16"-16 Nylock Nut
- ★ 3/8"-16 x 1" SBHC Screw

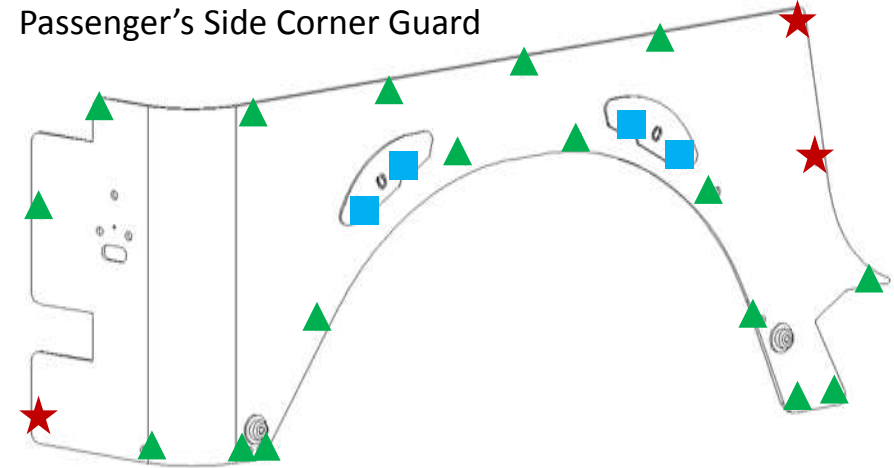
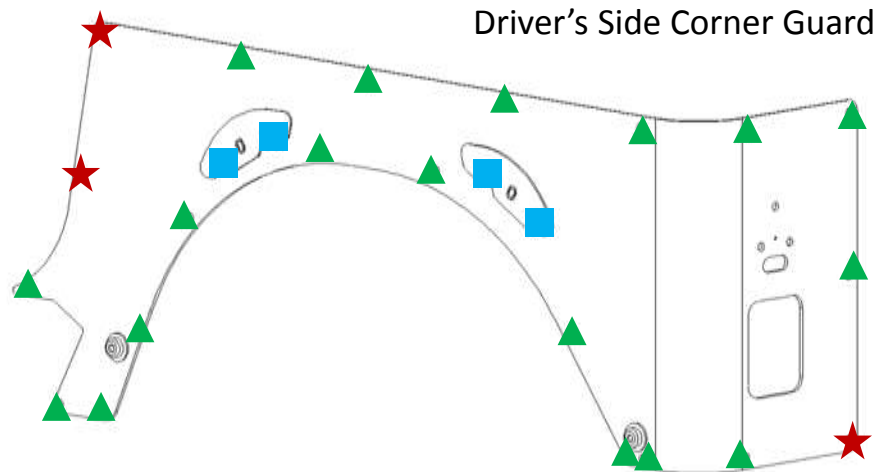

Install flare retaining fasteners. ■  
Install 3/8"-16 x 1 1/4" SBHC Screws(D), 3/8" washers(E) and Backing Plates(F) as shown. If a MetalCloak Rear Flare is to be installed leave these fasteners loose(G) but in place. If a MetalCloak Rear Flare is NOT to be installed fully tighten fasteners(H).



## Section 3: Installation Instructions

### Step 2: Re-install stock components

Re-install Gas Tank Fill Spout Plastic Retainer(A) by center punching holes with Plastic Retainer as a guide. Drill holes using a 5/32" drill bit and re-install stock self tapping screws using ratchet.



Re-install Rear Brake/Marker Housings(B) by reconnecting wiring harness, reinstalling three hex head cap screws inside the Brake/Marker Housing in existing holes and reinstalling red transparent cover plate with the four Phillips head screws(C) located at the corners of the Rear Brake/Blinker Housing.

Re-install the license plate holder. Using a screwdriver (B), pry springs up and outwards to release from normal position, this will allow for easier center punching. Position license plate holder in desired position and center punch through two mounting holes(C) in license plate holder. Drill holes at center punch locations using a 5/32" drill. Replace spring. Install self-tapping stock screws (D) through license plate holder into Corner Guard.

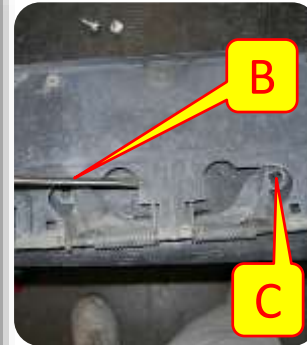

### Step 3: Install MetalCloak Rear Flares and Cut/Grind clearance for larger tires in Jeep Body

Follow MetalCloak Rear Flare Installation Instructions for Rear Flare installation(E).

The Wheel Well for the Corner Guard is designed to provide greater clearance for running larger diameter tires. At your option you may grind/cut/bend/paint the visible portion of the Jeep body (F).

